

# 8 Ideas

An Action Plan For

PROJECT RESTORE

**1st** now  
an Action Plan for PROJECT RESTORE

# Build on First Street

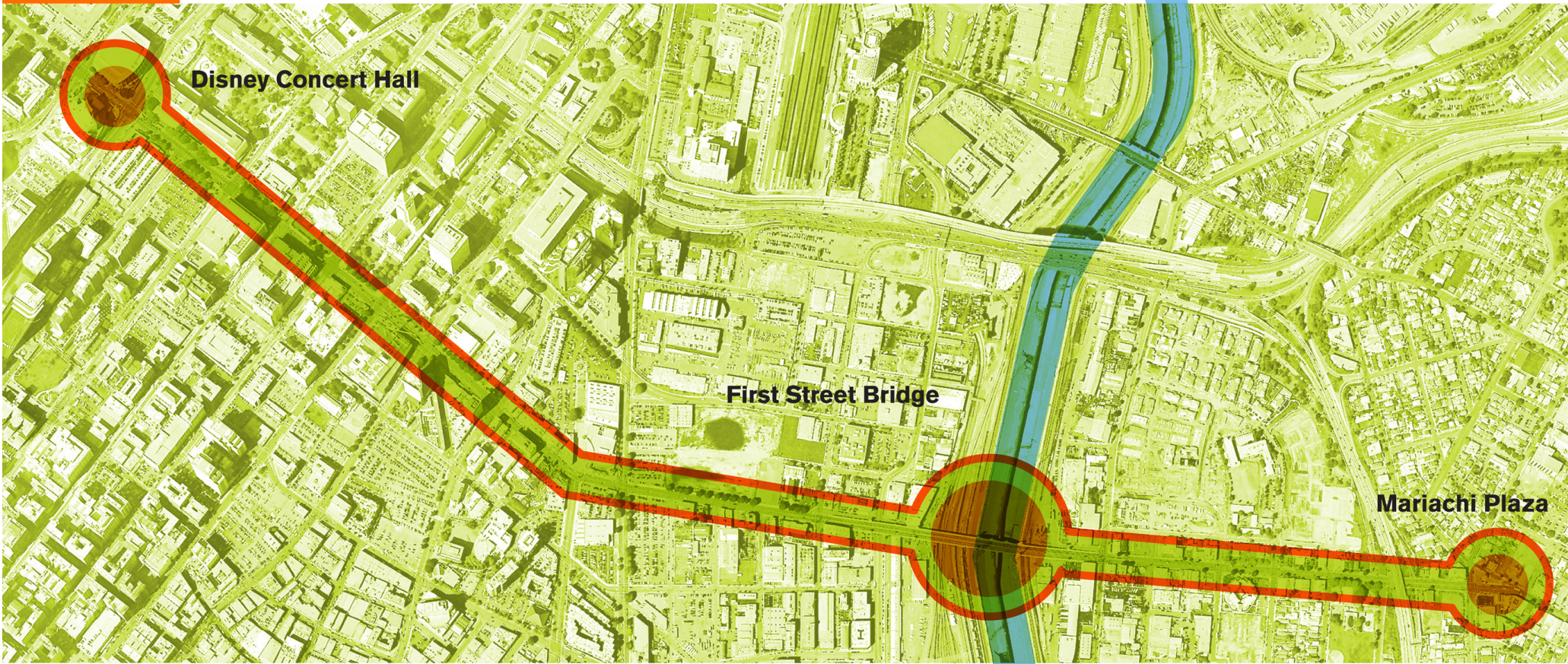

## Plant **Street Trees** to create a **Green Linear Promenade**

1

Shade trees, blossom trees and palm clusters to be planted along First Street.

Proposed tree list:  
Tipuana tipu, Koelreuteria bipinnata, Washingtonia robusta, Podocarpus gracilior, Tabebuia chrysostricha, Ficus macrophylla, Prunus serrulata, Ginkgo biloba.



**700** TREES

## Illuminate with **Special Streeights** to accent **Segment Character**

2

Four distinctive lighting schemes to accent four defined First Street Corridor segments. Special pedestrian lights, palm tree uplighting, street lighting and transit shelter lanterns for each segment.



**160** LIGHTS

## Incorporate **Design Elements** like paving, crosswalks, furniture & signage for **Pedestrian Activity**

3

Sustainable and low-waste furnishings, energy efficient lighting for streetlights and lanterns, porous paving materials -- all to be included in First Street's smart growth plan.

Also - special patterns for crosswalks and paving to symbolize First Street's connection to the Los Angeles River.



**70,350** CROSSWALK SF

## Provide a **New Transit Line** to **Connect Neighborhoods**

4

A variety of transportation choices including a continuous First Street Shuttle connecting Boyle Heights to Bunker Hill -- to decrease dependence on the automobile and to create a walkable neighborhood. Distinctive street lanterns to mark transit stops.



**2.3** mile CIRCULATOR

## Build a **Bridge Park** to engage the **Regional Landscape**

5

A wider 12-foot wide pedestrian walkway as part of the current Bridge Expansion Project on the northern sidewalk. 30,000 SF of usable space underneath the bridge to be developed as a retail promenade. New and relocated stairs at east and west bridge gateways to provide access to lower level developments and the Los Angeles River.

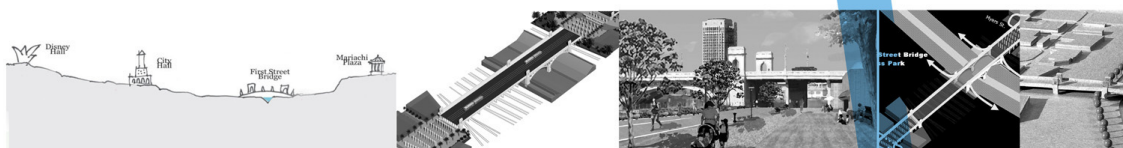

**16** FOOT wide PATH PEDESTRIAN

## Create a **Civic Square** to be the **Heart of Civic Life**

6

An open civic plaza spanning from City Hall across First Street to the New Police Headquarters. A large, continuous and flexible space for civic activity.



**75,000** sf PARK

## Adopt **Streetscape Guidelines** to ensure **First Street Happens Now**

7

An approved set of guidelines that encourages participation by stakeholders and implementation by developers in the Big Vision for the First Street Corridor.

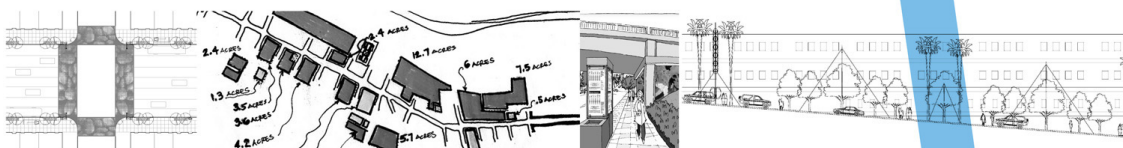

**4m** sf CURRENTLY UNDER DEVELOPMENT

## Organize **Program Management** to bring **First Street's Vision to Reality**

8

A new task force to be established that is responsible for overseeing the implementation of First Street's guidelines.

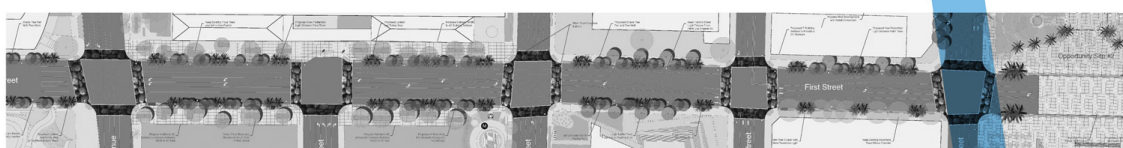

**now!**